

Product Name: Petal Soft Silicone Milk Collector

Materials: Collector - Medical-Grade Silicone
Tube Cleaning Brush - Nylon, Stainless Steel

Dimensions: 1/2 Milk Collector(s) - 110 x 110 x 41mm
1 x Tube Cleaning Brush - 6 x 5 x 92mm

Product Description:

The Haakaa Petal Soft Silicone Milk Collector is the perfect breast pad alternative for mums who want to save every last drop of leakage and let-down instead of letting it go to waste. The one-piece design shapes to your breast and sits securely and discreetly in your bra. It won't draw out additional milk, so it's ideal for mums who leak breastmilk and want to save it without increasing their supply. The scalloped shape and contoured design accommodate most breast shapes and sizes for an unobtrusive fit. Made of premium, ultra-soft medical-grade silicone, it helps keep your milk safe and remains comfortable as you go about your day! With internal supports that hold the Petal's shape without having to worry about it collapsing or deforming, you can move with ease without fear of accidental spills or leaks. Once you've finished collecting your let-down or leakage, simply pour your milk safely through the curved opening into a container or bottle. We've even included a dedicated brush to help you reach each and every corner for the most thorough of cleans.

Features:

- The breast pad alternative that saves your leakage instead of soaking it up.
- Efficiently collects let-down without drawing out extra milk.
- The ultimate in comfort and discreet convenience – collect every precious drop anywhere, anytime.
- Made of 100% medical-grade silicone, so no harmful chemicals touch your liquid gold.
- Slim, form-fitting petal shape for a discreet, natural look under everyday clothing.
- Internal silicone supports help the collector keep its shape and prevent leaks while moving.
- Ultra-soft, lightweight and compact for all-day wearing*.
- Convenient curved opening for easy milk transfer.
- Lies stably on its back for safe storage on flat surfaces between uses.
- Easy-care one-piece design - use the dedicated brush to thoroughly clean small corners then boil to sterilise.
- BPA, PVC and phthalate-free.

*If planning to feed collected milk to your baby, ensure collector is regularly emptied and milk stored according to safe storage guidelines.

Cleaning and Care:

Wash before and after each use. Although dishwasher safe, we recommend hand washing with warm, soapy water and rinsing thoroughly. To sterilise the collector, use a steam steriliser or boil in water for 2-3 minutes. Only soft bristle brushes or soft sponges should be used to clean this product as hard scourers may scratch the surface. Do not use any bleach-based cleaners or tablets to clean or sterilise your Haakaa products. Store product in a cool, dry place and avoid direct sunlight.

Instructions:



Centre the main opening over your nipple and hold to your breast.

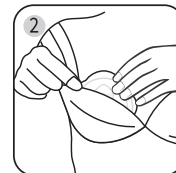

Wear inside your bra to begin collecting let-down. The supports help minimise leaks during use so there is no need to press the back of your collector.

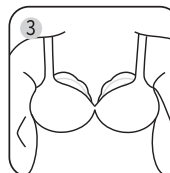

Wear the Petal on the other side while nursing to collect let-down or wear one on each breast to collect leakage.



The Petal can be worn while lying down – ensure Petal is secure inside your bra while lying down.

Caution:

- For adult use only.
- Before each use, inspect the product. Throw away at the first sign of damage or weakness.
- This product is not a toy. Do not use this product for anything other than its intended use.
- Keep out of reach of children and pets when not in use.
- Do not store near any sharp objects.
- Do not use the Petal while vigorously exercising or operating heavy machinery.
- Your silicone products may grow cloudy after repeated use, especially in hard water areas. This is normal and will not affect the performance of your product.

NOTE: The Petal will only collect milk that would otherwise have soaked into breast pads. It won't draw out extra milk.

Please ensure you are familiar with your country's guidelines on the safe storage of breastmilk, and ensure your Petal is emptied regularly to store your breastmilk in accordance with these recommendations.