

Product Name: 360° Silicone Toothbrush
Material: Food-Grade Silicone
Dimensions: 124 x 47 x 42mm
Colours: Blue/Pink/Clear/Blush/Cream/Steel Blue/Pea Green
Recommended Age: 6 months+

Product Description:

The Haakaa 360° Silicone Toothbrush is designed to give your little one an effective cleaning experience when brushing their little teeth and gums. The soft silicone bristles provide a 360° clean, making it easier to brush than using conventional children's toothbrushes!

Our 360° Toothbrush is made from soft 100% food-grade silicone and is completely safe for babies, massaging and cleaning their delicate new teeth and gums. It also has a suction base to make it easier to store without it tipping over, keeping the bristles clean and free from germs and other nasties. It's the perfect brush for starting your child's dental care, helping to instil good dental hygiene habits from a young age.

Features:

- The fun and easy way to care for little teeth and gums!
- Made of 100% food-grade silicone, contains no plastic nasties.
- Safe to chew and explore while providing a 360° clean.
- Carefully soothes tender teething gums.
- Encourages good dental hygiene habits from an early age.
- Silicone shield guard to prevent choking hazards.
- BPA, PVC and phthalate-free.

Cleaning and Care:

Clean before initial use, then clean after each use. Although dishwasher safe, we recommend hand washing this product in warm, soapy water and rinsing and drying thoroughly. To sterilise, use a steam steriliser or boil in water for 2-3 minutes. Do not use bleach-based agents to clean this product. Store product in a cool, dry place and avoid direct sunlight. We recommend replacing your child's toothbrush every 3-4 months.

Caution:

- For your child's safety, never attach product to cords, ribbons, laces or loose parts of clothing, as it can become wrapped around their neck.
- Check product condition regularly. Replace if this product shows any signs of damage.
- Do not store near any sharp objects. Hard scourers may scratch the surface.
- This product is not a toy. Do not use this product for anything other than its intended use.
- Adult supervision is required at all times.
- Keep out of reach of children and pets when not in use.

Instructions:

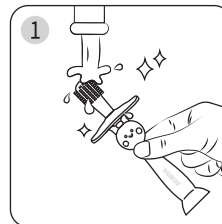

Clean and sterilise the toothbrush before use according to Cleaning & Care instructions.

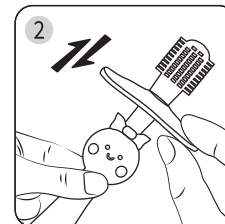

Adjust the shield guard's position to suit your baby's needs.

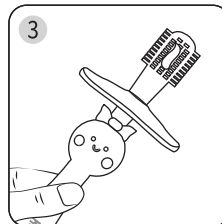

Wet the bristles with warm water before giving to baby. Apply baby-safe toothpaste* if needed.



Let your child grab and chew the toothbrush to clean their teeth and gums.

***PLEASE NOTE:** Only use small amounts of baby-safe toothpaste after teeth emerge. Follow your dentist's guidelines around the use of toothpaste for children.